

VERTICAL IMMERSION PUMPS

Series D13 - PP



D13-12-300-PP

2000 - 12000 l/h

33 - 200 l/min

Vertical single stage centrifugal immersion pump, sealless and dry-run safe for non-pressurized tank application.

The D13 series combines maximum hydraulic efficiency with a robust, compact and reliable construction, resulting in maximum installation uptime and a long service life.

Features

- Very easy, leak free, in-tank installation
- Easy connection above cover, no outlet pipe required
- Including complete +GF+ union end
- Free turning shaft, no seal or bearing, can run dry
- Self priming when flooded
- EPDM elastomers
- Including suction strainer
- Max. temperature 80°C
- High quality European, purpose designed electric motor:
 - 3 phase, 50/60 Hz, 2900/3500 rpm, IP55, multi voltage
 - with double layer 2C chemical resistant coating
 - full length SS shaft with PP protection pipe
 - including PP drip cover, fan cover and wiring box
 - suitable for frequency drive control
 - stainless steel fasteners

Options

- Customised mounting plate
- Suction extension pipe
- Outlet connection with elbow
- FIP trapezoidal threaded outlet
- Hose connection
- Union socket in PVC or CPVC
- Specific elastomers
- Fixation securing the pump
- Version for < 230 Volt
- Electric motor options:
 - EMC compatibility
 - single phase
 - electrical lead (4 m)
 - filter pad for fan cover
 - other RAL colours

Type	Material	Q max (l/h)	H max (m)	Motor kW HP	I nom. (A) 400V-50Hz	Out (d/DN)	Immersion length (mm) incl. strainer	Net weight (kg)
D13-08-300	PP	8000	6,5	0,18 1/4	0,7	32/25	400	9
D13-10-300		10000	8,5	0,25 1/3	1,2			10
D13-12-300		12000	9,5	0,37 1/2	1,5			12

Selection example: D13-12-300-PP

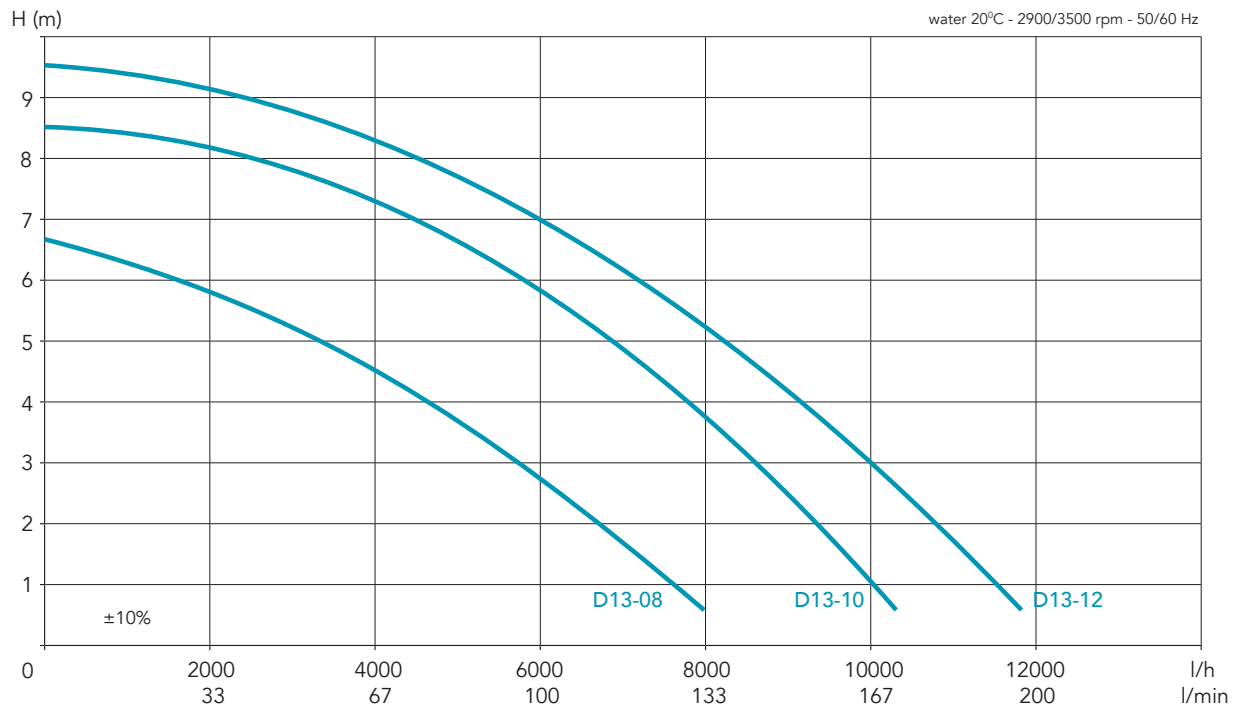

Exploded view

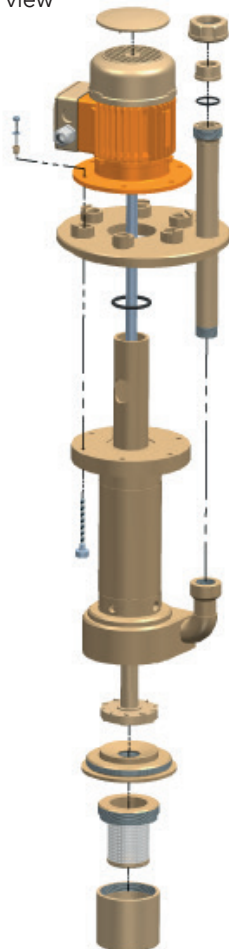

Dimensions

Type	"B"
D13-08-300	223
D13-10-300	223
D13-12-300	242

